



## Gladstone Ports Corporation

*Growth, Prosperity, Community.*

GPC Document No. 1533554  
GPC Ref: DA2019/06  
Your Ref.:

20 January 2020

Mathew Giles  
Downer EDI Power Pty Ltd  
7 Rooksby Street  
GLADSTONE QLD 4680

Email: [mathew.giles@downergroup.com](mailto:mathew.giles@downergroup.com)

Dear Mr Giles

### DECISION NOTICE – APPROVAL WITH CONDITIONS – DA2019/06

(GIVEN UNDER THE PROVISIONS OF GLADSTONE PORTS CORPORATION LAND USE PLAN 2012)

#### 1. Application Details

This development application was **properly made** to the Gladstone Ports Corporation Limited on **8 August 2019**.

Application Number:	DA2019/06
Applicant Name:	Downer EDI Power Pty Ltd
Applicant Contact Details:	Mathew Giles Downer EDI Power Pty Ltd 7 Rooksby Street GLADSTONE QLD 4680 Email: <a href="mailto:mathew.giles@downergroup.com">mathew.giles@downergroup.com</a>
Approvals Sought:	Port application for new painting and blasting shed
Details of Proposed Development:	Painting and blasting shed
Location Street Address:	7-11 Rooksby Street GLADSTONE QLD 4680
Location Real Property Description:	Lease HRV on SP127796 in Lot 900 on SP159699
Land Owner:	Gladstone Ports Corporation Limited
Present Zoning & Precinct	Strategic Port Land – Light Industry and Commercial Precinct

## 2. Details Of Proposed Development

Indoor blasting and painting facility including an air filtration unit.

## 3. Details Of Decision

This development application was **decided** on **20 January 2020**.

This development application is **approved in full with conditions**. These conditions are set out in Attachment 1 and are clearly identified to indicate whether the assessment manager or a concurrence agency imposed them.

## 4. Details Of Approval

This development approval is a **Development Permit** given for:

- a) Port Application for undertaking work in, on over or under premises that materially affects the premises or their use including excavating or filling (*GPC Land Use Plan 2012v2*).

## 5. Conditions

This development approval is subject to the conditions in Attachment 1 - Part 1 and Part 2.

## 6. Further Development Permits

Please be advised that the following development permits are required to be obtained before the development can be carried out:

1. Any Building Work approvals required;
2. Any Plumbing and Drainage Work approvals required.

## 7. Properly made submissions

Not applicable – No part of the application required public notification.

## 8. Approved Plans and Specifications –

Copies of the following plans, specifications or drawings are enclosed in **Attachment 2**:

Drawing/report title	Prepared by	Date	Reference no.	Version
<b>Aspect of development: Port Application</b>				
Site layout	Downer	22/07/2019	BAP-ROOKSY-3821502_1-001 t	2
Blast workshop – 2 point projectional	Downer	22/07/2019	BAP-ROOKSY-3821502_1-002 t	2
Blast workshop – top view	Downer	22/07/2019	BAP-ROOKSY-3821502_1-003 t	2
Blast workshop – top view-blast side	Downer	22/07/2019	BAP-ROOKSY-3821502_1-003a t	2
Blast workshop – top view-paint side	Downer	22/07/2019	BAP-ROOKSY-3821502_1-003b t	2

Drawing/report title	Prepared by	Date	Reference no.	Version
Blast workshop – internal door (none structural)	Downer	22/07/2019	BAP-ROOKSY-3821502_1-004 t	2
Blast workshop – internal door (none structural)	Downer	22/07/2019	BAP-ROOKSY-3821502_1-005 t	2
Wall cladding	Downer	22/07/2019	BAP-ROOKSY-3821502_1-006 t	2
Paint filtration system	Downer	22/07/2019	BAP-ROOKSY-3821502_1-007A t	2
Paint filtration system	Downer	22/07/2019	BAP-ROOKSY-3821502_1-007B t	2
Material list	Downer	22/07/2019	BAP-ROOKSY-3821502_1-008 t	2

## 9. Currency Period for the Approval

This development approval will lapse at the end of the periods set out below:

- For Port Applications this approval lapses 6 years after this approval decision date.

## 10. Rights of Appeal

No legislated appeal rights are afforded with this decision notice in relation to the Port Application as the application was not made under the provisions of the *Planning Act 2016*.

For further information please contact Judy Horsfall, Planning Officer on 07 4976 1314 or via email [horsfallj@gpcl.com.au](mailto:horsfallj@gpcl.com.au) or Erin Clark, Principal Planner, on 07 4976 1287 or via email [clarke@gpcl.com.au](mailto:clarke@gpcl.com.au).

Yours sincerely



**Erin Clark**  
**Principal Planner**  
20 January 2020

- Enc. Attachment 1: Conditions of Approval  
Part 1 – Conditions imposed by the assessment manager
- Attachment 2: Approved plans and specifications

# ATTACHMENT 1: CONDITIONS OF APPROVAL

## PART 1: ASSESSMENT MANAGER CONDITIONS

In general the development proposal is in compliance with the requirements of Gladstone Ports Corporation Limited (GPC). This development approval is subject to each of the following conditions which are stated by Gladstone Ports Corporation Limited, the assessment manager.

### Part 1a: Approval sought under GPC Land Use Plan 2012v2 – Port Application

#### GENERAL

1. The development must be carried out generally in accordance with the plans as lodged with the application except where modified by conditions of this permit.
2. Unless otherwise stated, all conditions must be completed prior to the commencement of the use.
3. Where additional “approval” is required under these conditions by GPC for drawings or documentation, the proponent must submit for review, amend to the satisfaction of, and obtain written acceptance from the Gladstone Ports Corporation. Only in this manner can compliance with the condition be achieved.
4. All other relevant regulatory approvals must be obtained before commencement of works or operation of the facility.
5. The proponent must at its cost and expense, keep and maintain the subject area, including existing services, in a state that is satisfactory to the Port.

#### ENGINEERING & PLANNING

6. Upon completion of the works, the proponent must supply GPC with RPEQ certified “As Constructed” plans in both hard copy (2 of) and electronic (CAD format) which illustrate all infrastructure and services installed on Port land associated with the activity.
7. The development must be undertaken in general accordance with:
  - (a) Australian Standards/NZS 4114.1: Spray painting booths, designated spray painting areas and paint mixing rooms – Design, construction and testing; and
  - (b) AS/NZS 4114.2: Spray painting booths, designated spray painting areas and painting mixing rooms – Installation and maintenance.
8. The proponent must obtain certification for plumbing and drainage work and for building work as required by legislation.
9. Any site lighting used during construction should not impact on the visibility of Navigational Aids utilised for the primary shipping channels nor illuminate a landward glare beyond the site boundary. Lighting must be continually reviewed during construction and operations with respect to navigation and will be revised as required in response to negative impacts as they arise.
10. The hours for the construction of the facility (i.e. operation of any machinery and/or other equipment) shall be restricted to between 6.30am and 6:30pm Monday to Friday and 6.30am to 12.30pm Saturday. No works shall be undertaken on Sunday or on public holidays. Any variations to these times will be subject to the written approval of GPC.

## **ENVIRONMENT**

### **Environmental Management Plan**

11. The development must be undertaken in accordance with the approved Environmental Management Plan Gladstone Workshop Rooksby Street, No. 382159 DI-PM\_TP036 Version 1, Rev.004 dated 18/12/2019.
12. Any amendments to the Environmental Management Plan (EMP) are to be submitted to GPC for review and approval. Amendments must ensure:
  - (a) environmental risks are identified, managed and continually assessed; and
  - (b) that staff are trained and aware of their obligations under the EMP; and
  - (c) that reviews of environmental performance are undertaken at least annually.
13. Submit documentation for approval by the Assessment Manager (GPC), within six months of the date of this decision notice, to demonstrate compliance with proposed noise assessment and mitigation measures mentioned in section 14.4 of the EMP. Where recommendations are required for compliance, the development is to be constructed and carried out in accordance with these measures.

### **Incident notification**

14. Gladstone Ports Corporation Environment Hotline (07) 4976 1617 is to be notified of the occurrence of any:
  - (a) release / spill of contaminants (e.g. fuels / chemicals / sewerage) greater than 250L to land;
  - (b) release / spill of contaminants (e.g. fuels / chemicals / sewerage) of any amount to water;
  - (c) any environmental complaints received by the holder of this approval; and
  - (d) non-compliance with conditions of this approval or any other environmental approval obtained in relation to the development.

# ATTACHMENT 2: APPROVED PLANS AND SPECIFICATIONS

MATERIAL LIST

DESCRIPTION	#	DRAWING REFERENCE	DESCRIPTION	#	DRAWING REFERENCE
JAMES HARDIE VILLABOARD 4200 X 1200 X 6MM FC LINING 5.04SQM	80	BAP_38215021-004, 5 & 6 t	CONSOLIDATED ALLOYS 110MM X 10M POLY COURSE	3	BAP_38215021-004 t
BRUTUS 6MM X 2.4M BUILDING MOULDING DIVISION	29	BAP_38215021-004, 5 & 6 t	ZENITH M8 HOT DIPPED GALVANISED FLAT WASHER - 200 PACK	2	BAP_38215021-004, 5 & 6 t
BRUTUS 6MM X 2.4M BUILDING MOULDING CAPPING	64	BAP_38215021-004, 5 & 6 t	ZENITH M8 X 50MM HOT DIPPED GALVANISED HEX HEAD BOLT AND NUTS - BOX OF 25	15	BAP_38215021-004, 5 & 6 t
BRUTUS 6MM X 2.4M BUILDING MOULDING MAXI COVER DIVISION	99	BAP_38215021-004, 5 & 6 t	SIKA 750ML FIRE RATED PU EXPANDING FOAM	12	BAP_38215021-006 t
AUSTRALIAN HANDYMAN SUPPLIES 89 X 89MM X 3.0M GALVANISED STEEL FENCING POST	12	BAP_38215021-003 & 4 t	RAMSET 12 X 75MM DYNABOLT PLUS HEX NUT BOLT - 100 PACK	1	BAP_38215021-004 t
70 X 35MM MGP10 H2F TERMITE TREATED BLUE PINE TIMBER FRAMING - 2.4M	36	BAP_38215021-004, 5 & 6 t	ZENITH 8 - 15 X 25MM GOLD PASSIVATED BUTTON HEAD TIMBER STITCHING SCREWS - 1000 PACK	10	BAP_38215021-004, 5 & 6 t
70 X 35MM MGP10 H2F TERMITE TREATED BLUE PINE TIMBER FRAMING - 4.8M	40	BAP_38215021-004, 5 & 6 t	100 X 6MM X 6.0M GALVANISED FLAT BAR	2	BAP_38215021-005 t
70 X 35MM MGP10 H2F TERMITE TREATED BLUE PINE TIMBER FRAMING - 5.1M	60	BAP_38215021-004, 5 & 6 t	12MM X 6.0M ROUND BAR	2	BAP_38215021-005 t
DURAGAL CHANNEL 100 X 50 X 4MM X 3.0M (TOP DOOR CHANNEL)	2	BAP_38215021-004 t	12MM MASONARY DRILL BIT	4	BAP_38215021-004 t
2.4M X 1.2M X 1.6MM TH GALVANISED SHEET	6	BAP_38215021-007B t	PAINT FILTER MATERIAL BURWELL TECHNOLOGIES 1301-2861	10M X 9M	BAP_38215021-007B t
0.8M GAL COIL DUCTING WITH FLANGED ENDS	13M	BAP_38215021-007A t	STAINLESS STEEL WIRE 6.4MM (BREAKING STRAIN 20.4KN WIREINDUSTRIALMARINE.COM.AU	8M	BAP_38215021-002 t
12MM TURNBUCKLE GRADE P 1T WLL	2	BAP_38215021-002 t	LOW PROFILE PURLIN MOUNTED ANCHOR 15KN - TRAPEZOIDAL ROOF SHEETING- AIMS INDUSTRIAL	2	BAP_38215021-002 t
6MM THIMBLE SST-6.0 NS-6.4 WIREINDUSTRIALMARINE.COM.AU	4	BAP_38215021-002 t	NICKEL SWAGE-6.4MM WIREINDUSTRIALMARINE.COM.AU	10	BAP_38215021-002 t
6MM WIRE ROPE SWEGE TOOL HST-0064 WIREINDUSTRIALMARINE.COM.AU	1	BAP_38215021-002 t	FILTRATION SOCK BURWELL TECHNOLOGIES 1302-6106	2	BAP_38215021-003A t

**APPROVED**

20/1/20

**DO NOT SCALE FROM DRAWING**

**PLEASE NOTE**

1. Drawings with the suffix "T" in the revision list are for Tender Purposes only. They are not to be used for construction. The right to amend any information on these drawings prior to tender is reserved.

2. The information contained hereon remains the property of Downer Power and it is to be used only in conjunction with the performance of work for which it was prepared. It is not to be used for any other purpose without written permission in express writing.

**CLIENT:** GLASGOW PORT CORPORATION

**PROJECT:** ROCKEY STREET FACILITY MODIFICATIONS AND REPAIRS

**DRW BY:** MILES

**DATE:** 27/07/19

**TITLE:** BLAT AND PAINT WORKSHOP

**DATE DESIGNED BY:** MILES

**DATE:** 28/04/19

**SCALE:** N/A

**DATE CHECKED BY:** MILES

**DATE:** 29/04/19

**APPROVED:** MILES

**DATE APPROVED:** 22/07/19

**DRWING No:** BAP-ROCKEY\_38215021-001

**REV No:**

**BY:**

**DATE:**

**REV No:**

**BY:**

**DATE:**

**Downer**

Relationships creating success

SHEET NO: A1

REVISED: 2

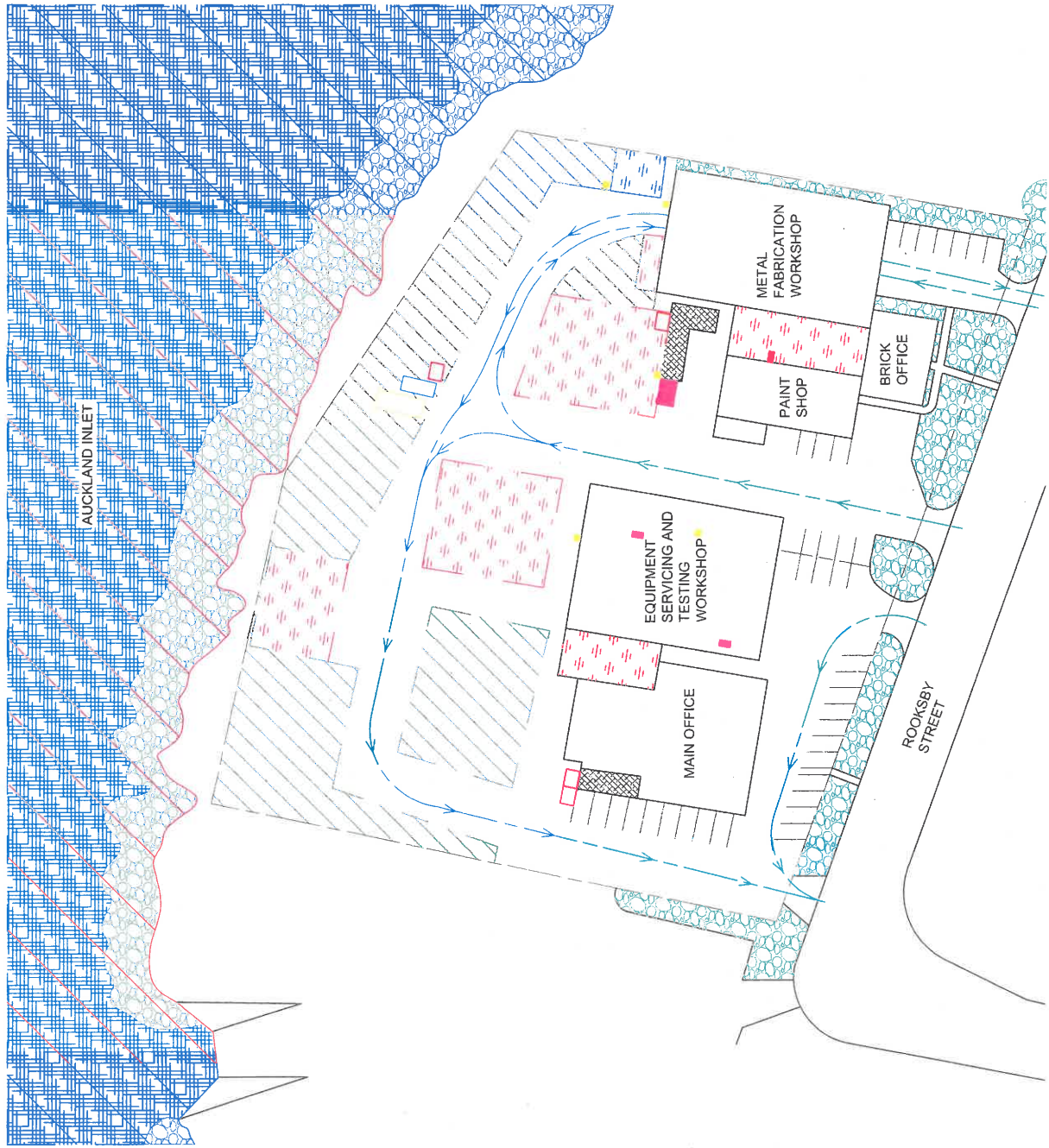

LEGEND

- VEGETATION
- ENVIRONMENTALLY SENSITIVE AREA
- WATER COURSE
- EQUIPMENT AND MATERIAL STORAGE
- WORKSHOP AND CONSUMABLE STORAGE
- CHEMICAL STORAGE
- TRAFFIC FLOW
- TOILET AND CRIB FACILITY
- FACILITY PERIMETER
- EXTERNAL BITUMEN AND CONCRETE
- SPILL KIT
- GENERAL WASTE BIN LOCATION
- STEEL BIN LOCATION
- WOOD BIN LOCATION
- RECYCLABLE BIN LOCATION

**APPROVED**  
20/1/20

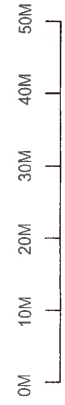

**DO NOT SCALE FROM DRAWING**

**PLEASE NOTE**  
 1 Drawings with the suffix "T" in the revision box are for Tender Purposes only. Downer Power (Downer Power Pty Ltd) reserves the right to amend the information contained herein without the consent of Downer Power and it to be used only in conjunction with the performance of work for Downer Power. Reproduction in whole or part without written permission is expressly forbidden.

NO	REV	DESCRIPTION	DATE
1			
2			

<b>CLIENT:</b> CLADSTONE PORT CORPORATION		<b>PROJECT:</b> ROOKSBY STREET FACILITY MODIFICATIONS AND REPAIRS	
<b>DRAWN BY:</b> MUGLES	<b>DATE:</b> 25/07/18	<b>TITLE:</b> EAST AND PAINT WORKSHOP - SITE LAYOUT	<b>SHEET SIZE:</b> A1
<b>DESIGNED BY:</b> MUGLES	<b>DATE:</b> 28/04/18		<b>REVISION:</b> 2
<b>CHKD BY:</b> MUGLES	<b>DATE:</b> 25/07/18		
<b>APP'D BY:</b> MUGLES	<b>DATE:</b> 25/07/18		
<b>SCALE:</b> N/A	<b>DRAWING No:</b> BAA-ROOKSBY_34210241-011		
<b>SCALE CODE:</b> N/A			



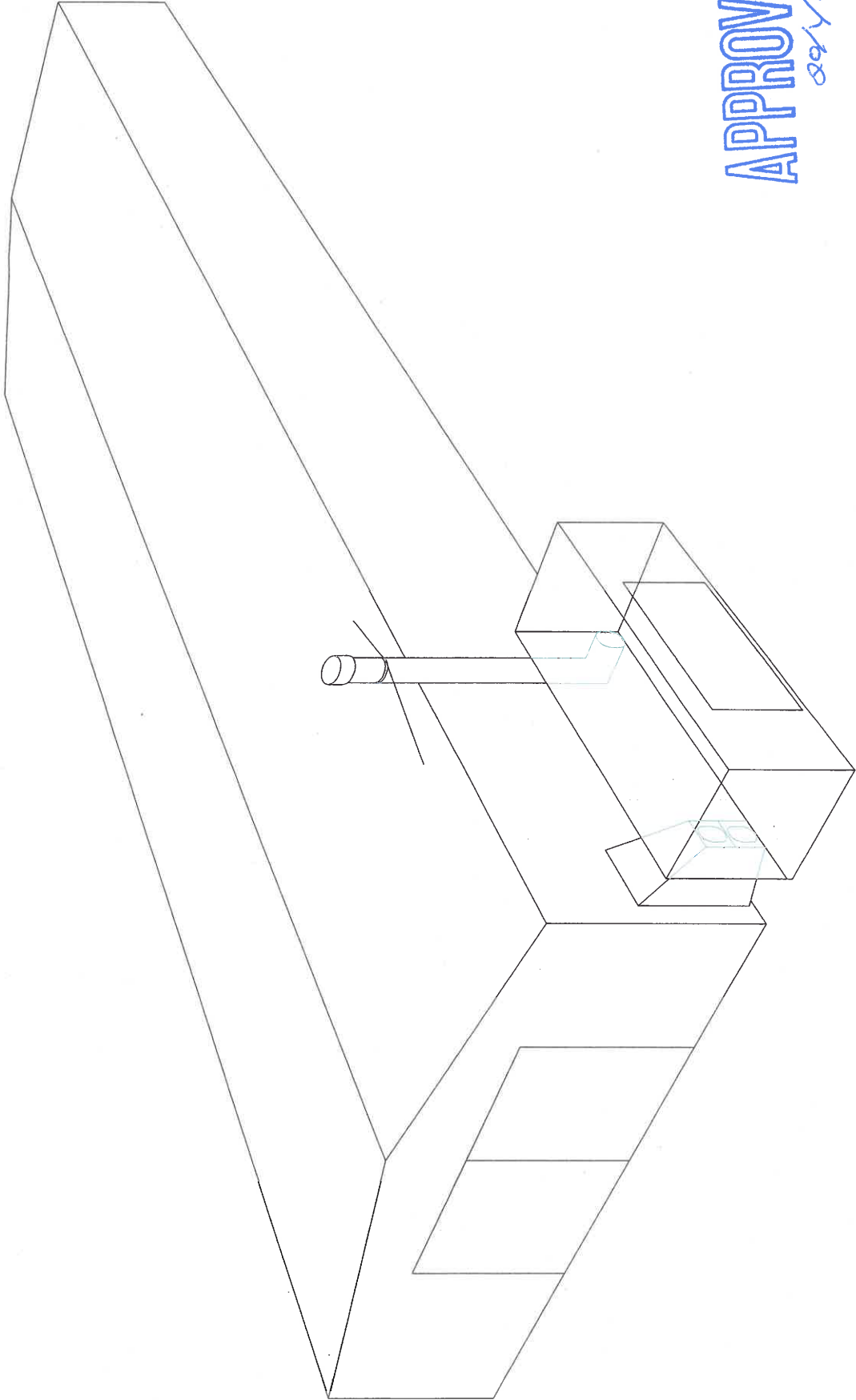
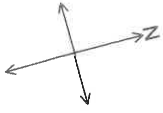

APPROVED

8/9/20

<p><b>DO NOT SCALE FROM DRAWING</b></p> <p>PLEASE NOTE</p> <p>1. Drawings with the suffix "T" in the revision box are for Tender Purposes only. Downer Power Pty Ltd reserves the right to amend any information on these drawings post Tender Award.</p> <p>2. Drawings with the suffix "R" in the revision box are for Revise Purposes and it is to be used only in conjunction with the purchase of work for Downer Power. Reproduction in whole or part without written permission is expressly forbidden.</p>	<p><b>CLIENT:</b> CLARE/TEMPE POINT CORPORATION</p> <p><b>DATE ISSUED BY:</b> 28/07/18 M. BLUES</p> <p><b>DATE:</b> 28/07/18</p> <p><b>FOR:</b> PROJECT OFFICE</p> <p><b>APPROVER:</b> CALEY/WK/MKS</p> <p><b>CAD FILE No:</b> BAP_2019241-002.dwg</p>	<p><b>PROJECT:</b> ROCKSBY STREET FACILITY MODIFICATIONS AND REPAIRS</p> <p><b>TITLE:</b> BLAST AND PAINT WORKSHOP - BLAST WORKSHOP-2 POINT PROJECTIONS</p> <p><b>DRAWING No:</b> BAP-ROCKSBY_2807202-0021</p> <p><b>SCALE:</b> N/A</p> <p><b>JOB CODE:</b> N/A</p>	<p style="text-align: right;"><b>SHEET SIZE:</b> A1</p> <p style="text-align: right;"><b>REVISION:</b> 2</p>																																			
	<p><b>REVISION DESCRIPTION:</b></p> <table border="1" style="width: 100%; border-collapse: collapse;"> <thead> <tr> <th style="width: 5%;">REV</th> <th style="width: 10%;">NO.</th> <th style="width: 85%;">DESCRIPTION</th> <th style="width: 5%;">DATE</th> </tr> </thead> <tbody> <tr> <td> </td> <td> </td> <td> </td> <td> </td> </tr> <tr> <td> </td> <td> </td> <td> </td> <td> </td> </tr> </tbody> </table>	REV	NO.	DESCRIPTION	DATE									<p><b>PROJ MANAGER:</b> M. BLUES</p> <p><b>DATE:</b> 28/07/18</p> <p><b>ISSUED BY:</b> M. BLUES</p> <p><b>DATE:</b> 28/07/18</p> <p><b>CHECKED BY:</b> M. BLUES</p> <p><b>DATE:</b> 28/07/18</p> <p><b>APPROVER:</b> M. BLUES</p> <p><b>DATE:</b> 28/07/18</p>	<p><b>PROJECT MANAGER:</b> M. BLUES</p> <p><b>DATE:</b> 28/07/18</p> <p><b>ISSUED BY:</b> M. BLUES</p> <p><b>DATE:</b> 28/07/18</p> <p><b>CHECKED BY:</b> M. BLUES</p> <p><b>DATE:</b> 28/07/18</p> <p><b>APPROVER:</b> M. BLUES</p> <p><b>DATE:</b> 28/07/18</p>	<table border="1" style="width: 100%; border-collapse: collapse;"> <thead> <tr> <th style="width: 5%;">NO.</th> <th style="width: 5%;">REV</th> <th style="width: 5%;">DATE</th> <th style="width: 5%;">BY</th> <th style="width: 5%;">APP'D</th> <th style="width: 5%;">DATE</th> <th style="width: 5%;">BY</th> <th style="width: 5%;">APP'D</th> <th style="width: 5%;">DATE</th> <th style="width: 5%;">BY</th> <th style="width: 5%;">APP'D</th> </tr> </thead> <tbody> <tr> <td> </td> <td> </td> <td> </td> <td> </td> <td> </td> <td> </td> <td> </td> <td> </td> <td> </td> <td> </td> <td> </td> </tr> </tbody> </table>	NO.	REV	DATE	BY	APP'D	DATE	BY	APP'D	DATE	BY	APP'D											
	REV	NO.	DESCRIPTION	DATE																																		
NO.	REV	DATE	BY	APP'D	DATE	BY	APP'D	DATE	BY	APP'D																												
<p><b>Downer</b></p> <p>Relationships creating success</p>																																						

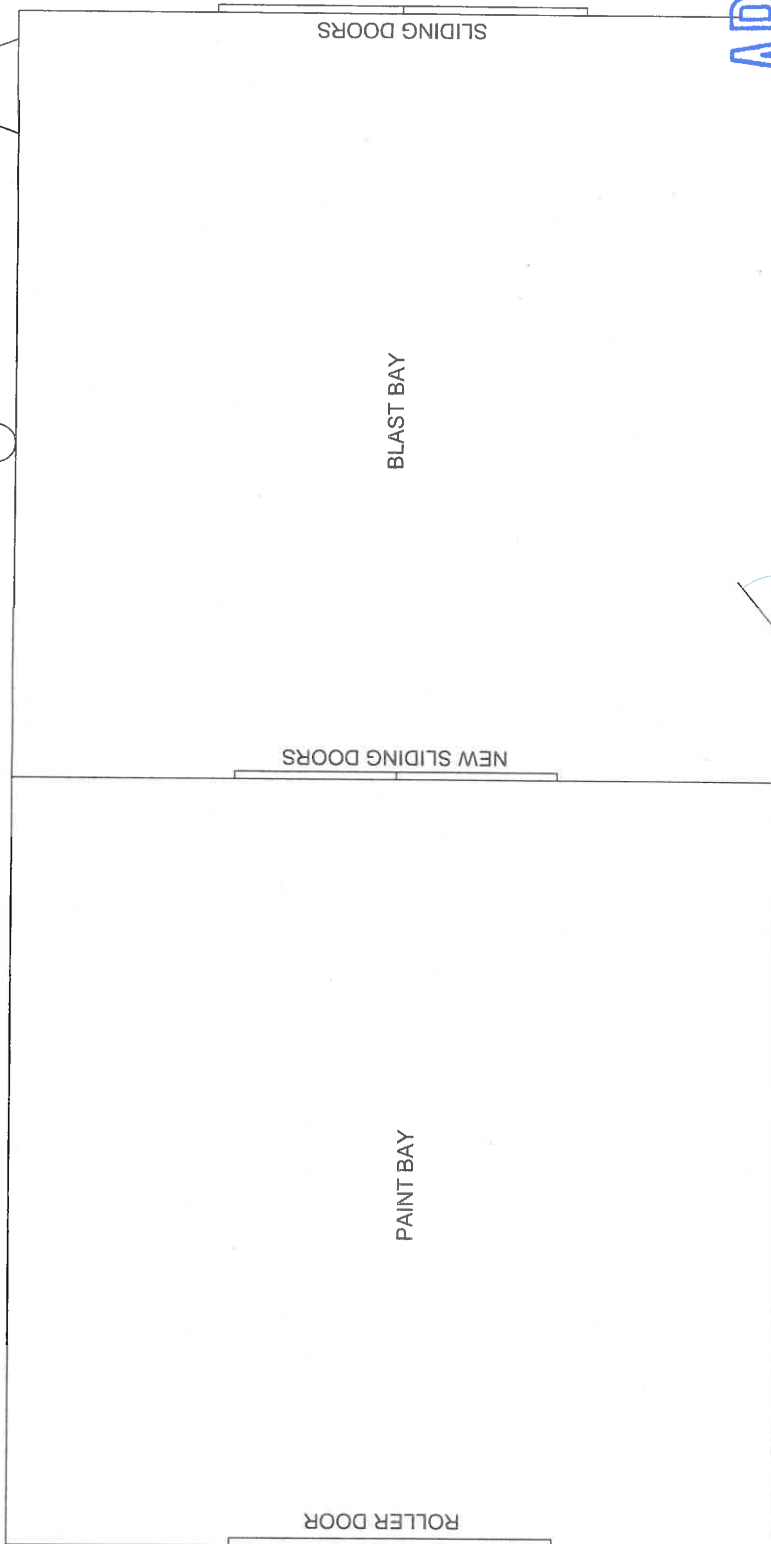
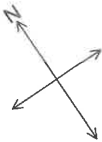

**APPROVED**  
20/1/20

**DO NOT SCALE FROM DRAWING**

PLEASE NOTE  
 1. Drawings with the suffix "T" in the revision box are for Tender Purposes only. Downer Power (Downer Power Pty Ltd) reserves the right to amend this information without further notice. This information is provided for information only and it is to be used only in conjunction with the performance of work for Downer Power. It is not to be reproduced in whole or part without written permission from Downer Power.

NO.	DATE	APPROVED	CHECKED	DATE
1	22/07/19			25/04/19
2	22/07/19			25/04/19
3				
4				
5				
6				
7				
8				
9				
10				
11				
12				
13				
14				
15				
16				
17				
18				
19				
20				



<b>CLIENT</b>	GLADSTONE PORT CORPORATION	<b>PROJECT</b>	ROCKNEY STREET FACILITY MODIFICATIONS AND REPAIRS
<b>DATE</b>	25/04/19	<b>DATE</b>	26/06/19
<b>DESCRIPTION</b>	BLAST BAY	<b>TITLE</b>	BLAST AND PAINT WORKSHOP - BLAST WORKSHOP - TOP VIEW
<b>DATE CHECKED BY</b>	22/07/19	<b>DATE</b>	25/04/19
<b>DATE</b>	22/07/19	<b>SCALE</b>	N/A
<b>APPROVED</b>	C/S/19/14/4468	<b>JOB CODE</b>	N/A
<b>CAD FILE NO.</b>	BAL_2025091-033.dwg	<b>DRAWING NO.</b>	BAL-ROCKNEY_30516031A003.1
<b>SHEET NO.</b>		<b>SHEET SIZE</b>	A1
<b>REVISION</b>		<b>REVISION</b>	2

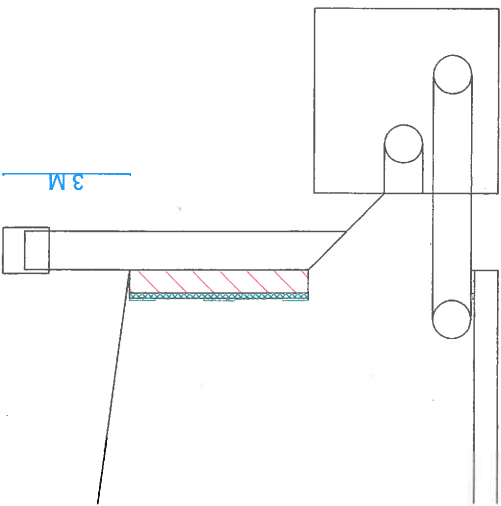

DETAIL A - FRONT VIEW

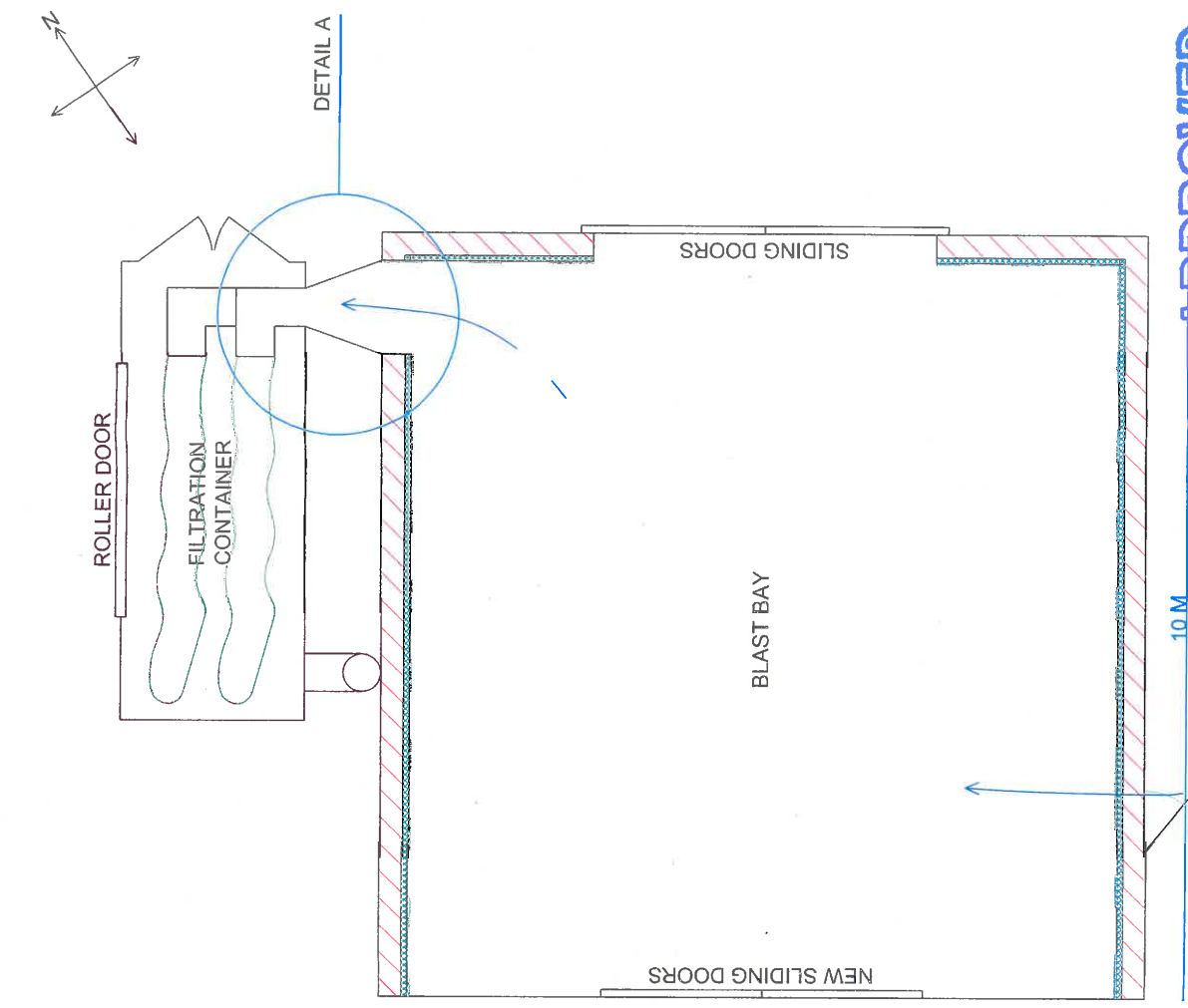

**APPROVED**  
20/1/20

**DO NOT SCALE FROM DRAWING**

**PLEASE NOTE**

1. Drawings with the suffix "C" in the revision box are for Tender Purposes only (Downer Power Pty Ltd) reserves the right to amend the information contained herein remains the property of Downer Power and it is to be used only in conjunction with the performance of work for which it was prepared. It shall be void if used for any other purpose without the express written permission of Downer Power Pty Ltd.

REV	No	REVISION DESCRIPTION	DRAWN BY		CHECKED BY		DATE	
			BY	DATE	BY	DATE	BY	DATE
1		INCLUSION OF FLU DUCT	MLG	CLC	MLG	CLC	15/01	20/01
2								
3								
4								
5								
6								
7								
8								
9								
10								



<b>CLIENT:</b> BRISTOLSTONE FORT CORPORATION	<b>PROJECT:</b> ROCKSBY STREET FACILITY MODIFICATIONS AND REPAIRS
<b>DRAWN BY:</b> MLG/CLC	<b>DATE:</b> 22/01/20
<b>DATE ISSUED BY:</b> MLG/CLC	<b>DATE:</b> 20/01/20
<b>DATE ORDERED BY:</b> MLG/CLC	<b>DATE:</b> 20/01/20
<b>DATE CHECKED BY:</b> MLG/CLC	<b>DATE:</b> 20/01/20
<b>DATE APPROVED BY:</b> MLG/CLC	<b>DATE:</b> 20/01/20
<b>SCALE:</b> N/A	<b>JOB CODE:</b> N/A
<b>DRAWING NO.:</b> R4P-ROCKSBY_20210214-00341	<b>REVISION:</b> 2

<b>SHEET SIZE:</b> A1
<b>REVISION:</b> 2

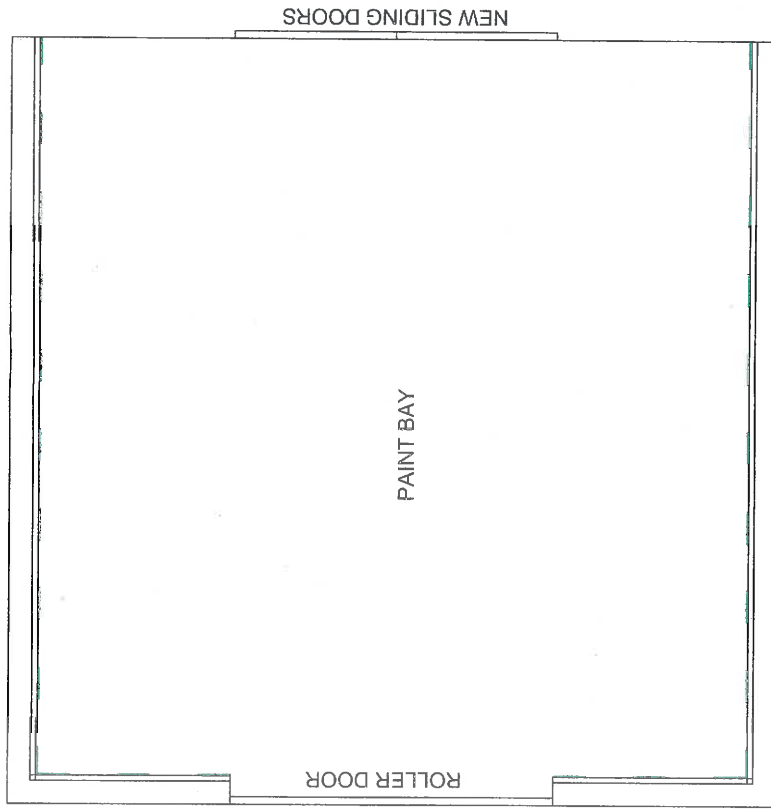
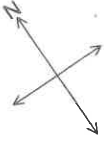

10 M

10 M

APPROVED

20/1/20

**DO NOT SCALE FROM DRAWING**

- PLEASE NOTE**
- Drawings with the suffix "R" in the revision box are for Tender Purposes only. Downer Power (Downer Power Pty Ltd) reserves the right to amend any information contained herein without the consent of Downer Power and it to be used only in conjunction with the performance of work for Downer Power. Reproduction in whole or part without written permission is expressly forbidden.

NO.	DATE	DESCRIPTION	BY	CHKD	APPROVED	DATE
1		READY TO ISSUE				

**Downer**  
Relationships creating success

DATE ISSUED BY:	DATE ISSUED BY:	DATE ISSUED BY:	DATE ISSUED BY:
22/07/19	22/07/19	22/07/19	22/07/19
SCALE	SCALE	SCALE	SCALE
1:1	1:1	1:1	1:1

PROJECT:	ROCKSBY STREET FACILITY MODIFICATIONS AND REPAIRS
TITLE:	BLAST AND PAINT WORKSHOP
DRAWING NO.	BSP-ROCKSBY_2016021-001
JOB CODE:	10A

SHEET SIZE	A1
REVISION	2

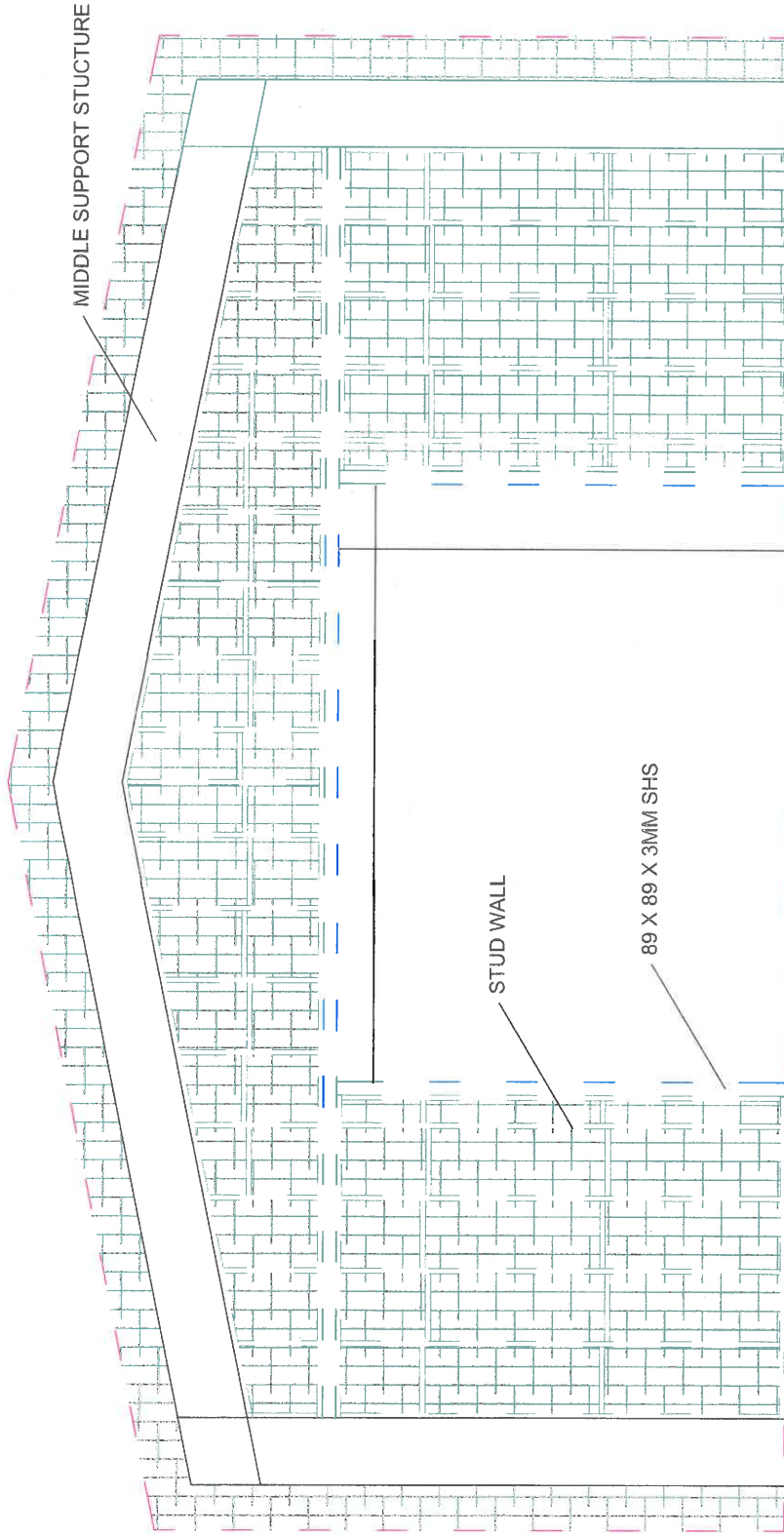
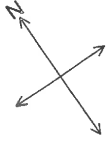

DYNABOLT STUD TO CONCRETE  
POLY COURSE USED TO STOP  
RISING DAMP

**APPROVED**  
20/1/20

**DO NOT SCALE FROM DRAWING**

- PLEASE NOTE**
- Drawings with the suffix "R" in the revision box are for Tender Purposes only. Downer Power (Downer Power Pty Ltd) reserves the right to amend drawings without notice. The information contained herein remains the property of Downer Power and is to be used only in conjunction with the performance of work for Downer Power. Reproduction in whole or part without written permission is expressly forbidden.
  -

NO	DATE	DESCRIPTION	BY	CHKD	APP'D	DATE
1						
2						



DATE	BY	DATE	BY
20/01/20	20/01/20	20/01/20	20/01/20
20/01/20	20/01/20	20/01/20	20/01/20

PROJECT TITLE	SCALE	DATE	DATE
ROOKSBY STREET FACILITY MODIFICATIONS AND REPAIRS	N/A	20/01/20	20/01/20
BLAST AND PAINT WORKSHOP BLAST WORKSHOP-INTERNAL WALL (MORE STRUCTURAL)	N/A	20/01/20	20/01/20

SHEET SIZE	REVISION
A1	2

DURAGAL CHANNEL  
SUPPORT FOR TOP  
OF DOOR

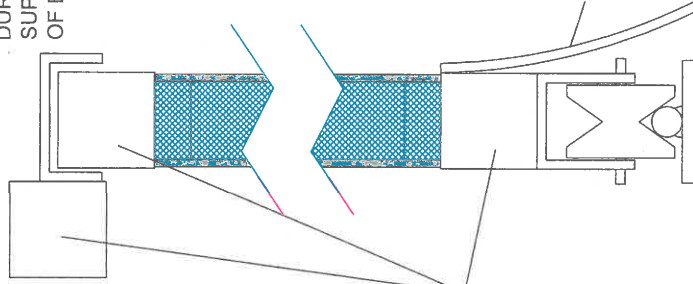

89 X 89 X 3 SHS

RUBBER ATTACHED  
ON BLAST SIDE

SLIDING DOOR X 2 TYPICAL

2.1 M

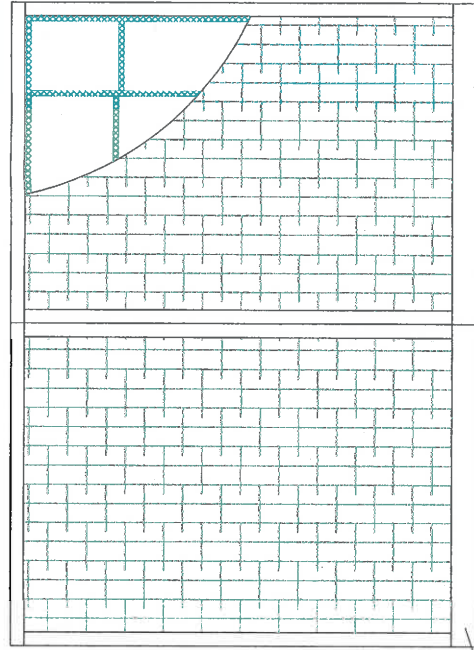

3.05 M

SLIDING DOOR X 2 TYPICAL

**APPROVED**

28/1/20

DO NOT SCALE FROM DRAWING

PLEASE NOTE  
1. Drawings with the suffix: 'P' in the revision box are for Tender Purposes only. Downer Power (Downer Power Pty Ltd) reserves the right to amend any information on these drawings post tender closure.  
2. Drawings with the suffix: 'M' in the revision box are for Downer Power and it is to be used only in conjunction with the performance of work for Downer Power. Reproduction in whole or part without written permission is expressly forbidden.

1 DRAFT  
1 READY TO ISSUE

BLK	CHK	SVA	LEC	DATE	BY	DESCRIPTION



CLIENT: GLADSTONE PORT CORPORATION  
PROJECT: ROKSEBY STREET FACILITY MODIFICATIONS AND REPAIRS

DRAWN BY: 220718-MLG  
DATE: 28/01/20  
CHECKED BY: 220718-MLG  
DATE: 28/01/20  
APPROVED: CALEVHANG  
DATE: 28/01/20

TITLE: BLAST AND PAINT WORKSHOP  
BLAST WORKSHOP INTERNAL DOOR (NORME STRUCTURAL)  
PROJECT: ROKSEBY STREET FACILITY MODIFICATIONS AND REPAIRS  
SCALE: N/A  
JOB CODE: N/A

SHEET NO: A1  
REVISION: 2

NO INSULATION

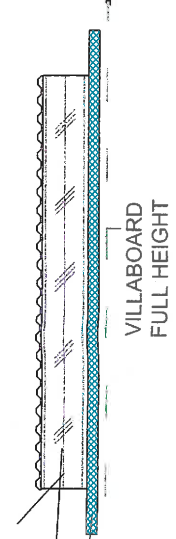

EXISTING C PURLIN  
SCREWED TO PURLIN  
70 X 35 H2 STUD  
PLASTIC JOINERS

VILLABOARD  
FULL HEIGHT

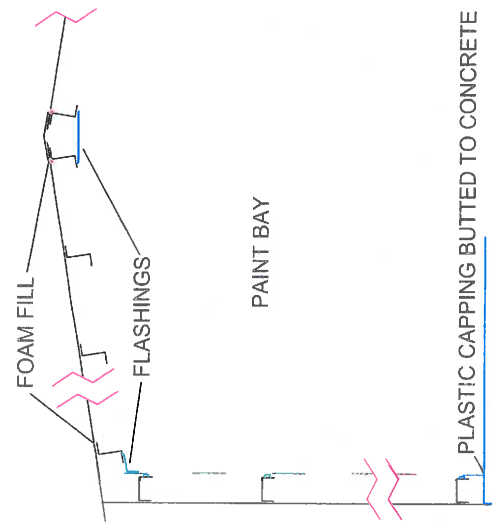

FOAM FILL  
FLASHINGS

PAINT BAY

PLASTIC CAPPING BUTTED TO CONCRETE

INDUSTRIAL INSULATION 350 DEG RATED  
LOOSE FILLED

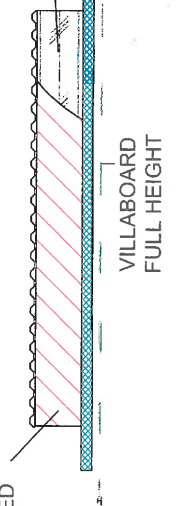

EXISTING C PURLIN  
SCREWED TO PURLIN  
70 X 35 H2 STUD  
PLASTIC JOINERS

VILLABOARD  
FULL HEIGHT

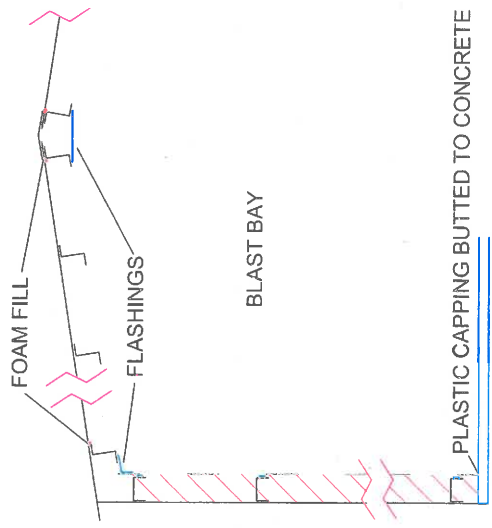

FOAM FILL  
FLASHINGS

BLAST BAY

PLASTIC CAPPING BUTTED TO CONCRETE

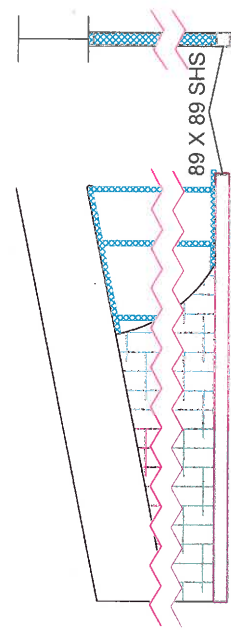

SIDE VIEW

DIVISIONAL WALL



BOTTOM VIEW

APPROVED  
20/1/20

**DO NOT SCALE FROM DRAWING**

PLEASE NOTE  
1. Drawings with the suffix "1" in the revision box are for Tender Purposes only. Downer Paper (Downer Paper Pty Ltd) reserves the right to amend the drawings without notice. The information contained herein is for the use of Downer Paper and it is to be used only in conjunction with the performance of work for Downer Paper. Reproduction in whole or part without written permission is expressly forbidden.

NO.	DATE	BY	CHKD	APP'D	DESCRIPTION
1					
2					
3					
4					
5					
6					
7					
8					
9					
10					

**Downer**  
Relationships creating success

DATE	BY	CHKD	APP'D	DESCRIPTION
20/01/20				

CLIENT: G3 KALBARNE PORT COGNACIZATION	PROJECT: ROCKSBY STREET FACILITY MODIFICATIONS AND REPAIRS	SHEET NO: A1
DESIGNED BY: M. GIBSON	TITLE: BLAST AND PAINT WORKSHOP WALL CLADDING	REVISION: 2
CHECKED BY: J. CALETRENAS	DATE: 20/01/20	DRAWING NO: BAP-ROCKSBY_STREET-10-001
DATE: 20/01/20	SCALE: N/A	JOB CODE: 100
CAD FILE NO: BAP_202001-10-001	APPROVED: J. CALETRENAS	

FABRICATED ELBOWS  
TO JOIN FAN TO SOCK

ROLLER DOOR FOR MAINTENANCE ACCESS

FILTRATION SOCK 2

FILTRATION SOCK 1

2 X 10,000 CFM FANS

FABRICATED FUNNEL TO DIRECT FLOW  
THROUGH FANS AND INTO SOCK

AIR FLOW  
DIRECTION

PAINT  
FILTER

**APPROVED**

20/1/20

**DO NOT SCALE FROM DRAWING**

- PLEASE NOTE**
- Drawings with the suffix "T" in the revision box are for Tender Purposes only and are not to be used for construction. The contractor shall verify all information on these drawings and shall be responsible for the accuracy of the information contained herein. The information contained herein remains the property of Downer Power and it is to be used only in conjunction with the performance of work for which it was issued. No liability is accepted in whole or part without written permission in separate form.
  - The information contained herein remains the property of Downer Power and it is to be used only in conjunction with the performance of work for which it was issued. No liability is accepted in whole or part without written permission in separate form.

NO.	REVISION DESCRIPTION	DATE	BY	CHECKED BY	DATE
1	DRAFT				
2	READY TO ISSUE				



CLIENT	GLADSTONE PORT CORPORATION
DATE	20/01/20
DESIGNED BY	M. G. C. K.
CHECKED BY	M. G. C. K.
DATE CHECKED BY	20/01/20
DATE	20/01/20
APPROVED	M. G. C. K.
DATE	20/01/20
CAD FILE No.	310_202001-01.dwg
CAD FILE No.	310_202001-01.dwg

PROJECT	ROCKSBY STREET FACILITY MODIFICATIONS AND REPAIRS
TITLE	BLAST AND PAINT WORKSHOP - PAINT FILTRATION SYSTEM
SCALE	1:100
JOB CODE	N/A
DRAWING No.	64-ROCKSBY_0615021007A1
SHEET SIZE	A1
REVISION	2



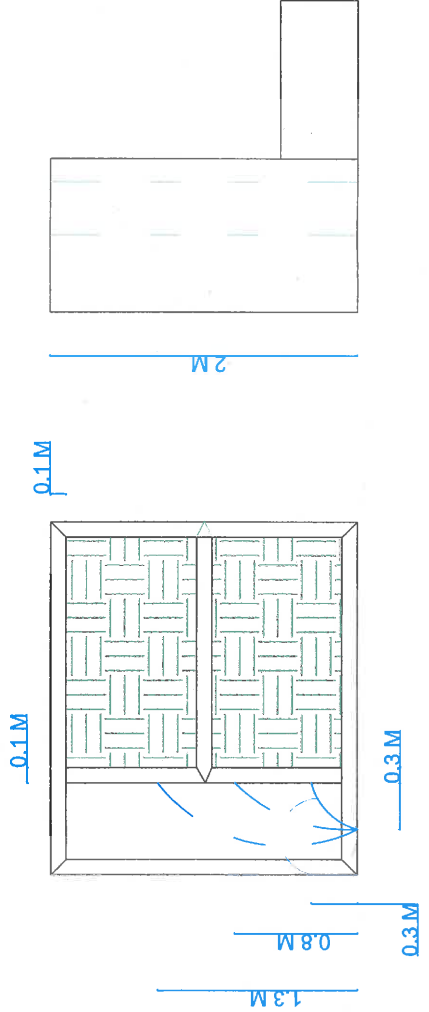
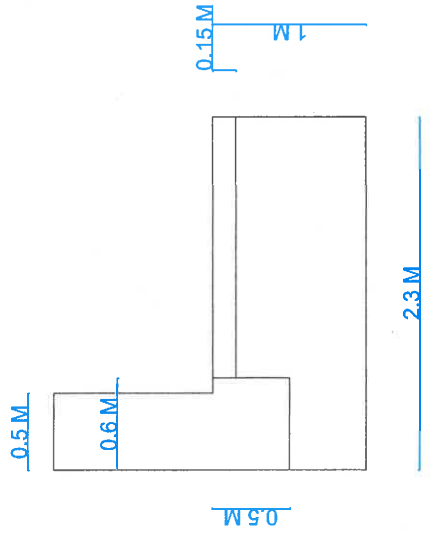
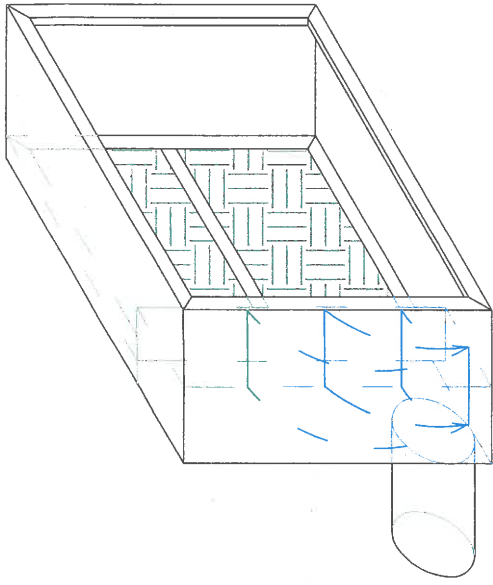

APPROVED

20/1/20

**DO NOT SCALE FROM DRAWING**

**PLEASE NOTE**

- Drawings with the suffix "T" in the revision box see for Tender Purposes only. Downer Power (Downer Power Pty Ltd) reserves the right to amend the drawings without notice. The information contained herein is the property of Downer Power and it is to be used only in conjunction with the performance of work for Downer Power. Reproduction in whole or part without written permission is expressly forbidden.

REV	NO.	DESCRIPTION	DATE
1			

NO.	DATE	BY	CHKD	DATE

NO.	DATE	BY	CHKD	DATE

NO.	DATE	BY	CHKD	DATE

**CLIENT:** GLADSTONE PORT CORPORATION  
**PROJECT:** ROCKSBY STREET FACILITY MODIFICATIONS AND REPAIRS  
**TITLE:** WASTEWATER TREATMENT PLANT PART-FILTRATION SYSTEM  
**DRAWN BY:** M. GILES  
**DATE:** 22/07/19  
**DESIGNED BY:** M. GILES  
**DATE:** 28/04/19  
**CHECKED BY:** M. GILES  
**DATE:** 28/04/19  
**APPROVED:** M. GILES  
**DATE:** 28/04/19  
**SCALE:** N/A  
**DRAWING NO.:** BWP-ROCKSBY\_20190214-0078  
**JOB CODE:** N/A  
**FILE NAME:** BWP\_20190214-0078.dwg

**Downer**  
 Relationships creating success

**SKETCH**  
**A1**  
**REVISION**  
**3**